

7. HOW TO DISASSEMBLE

BEFORE DISASSEMBLING THE DISHWASHER ;

- 1) Remove the plug from electric outlet to avoid electric shock.
- 2) Close the Water Tap(faucet).
- 3) Remove all dishes and items in the dishwasher.
- 4) Remove the Lower Rack and the Upper Rack.
- 5) In case of the water softner assembly model, open the water softner cap to flow out the water to sump and drain to avoid the floor wet.
- 6) If necessary, remove the inlet hose and drain hose to avoid the hose damages.
- 7) Prepare some towels to avoid floor wet by the water left in the dishwasher.

7-1. FULL DISASSEMBLE

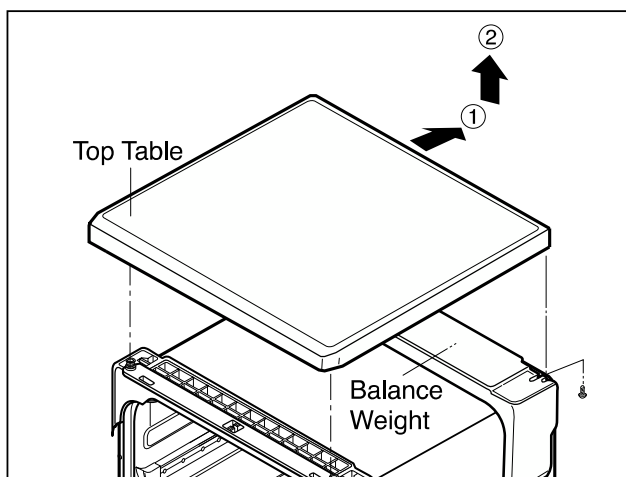

1. Top Table

- 1) Remove the rear 2 screws.
- 2) Pull and lift the top table.

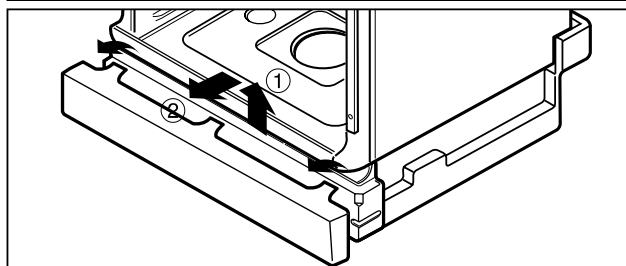

2. Low Cover

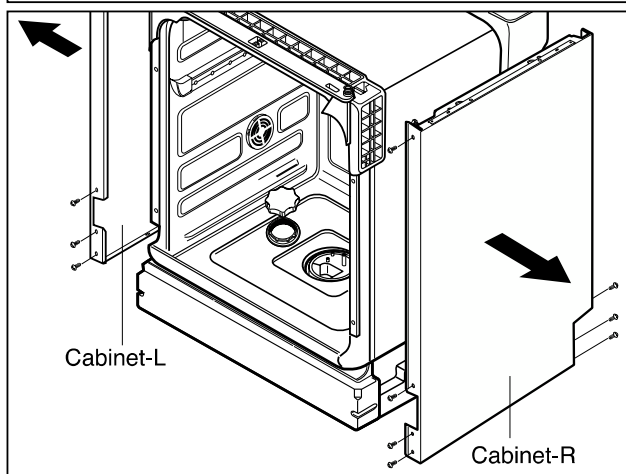

3. Cabinet-R/L

1) Cabinet-R

- ① Remove front 4 screws.
- ② Remove rear 3 screws.

2) Cabinet-L

- ① Remove front 4 screws.
- ② Remove rear 3 screws.

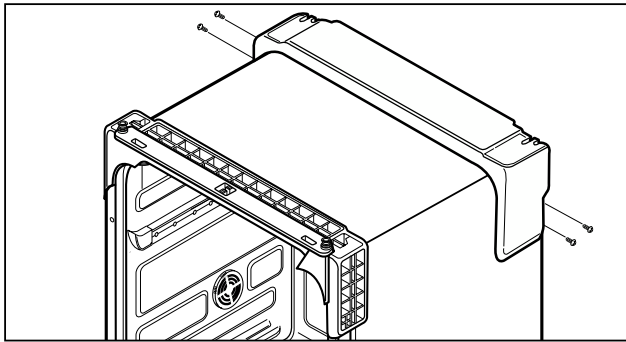

4. Balance weight

- 1) Remove side 4 screws.
- 2) Lift the balance weight.

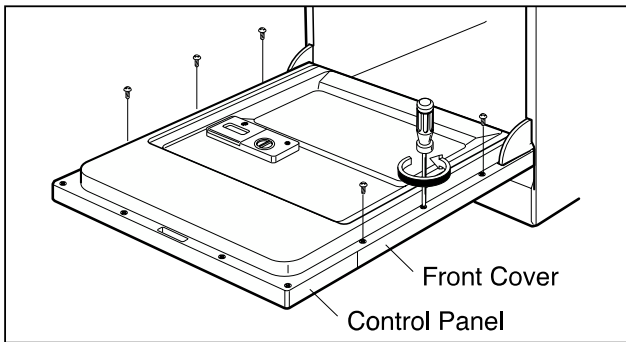

5. Door Assembly

1) Front Cover

- ① Open the door.
- ② Remove 6 screws(stainless).
- ③ Close the door slowly and remove front cover downwards.

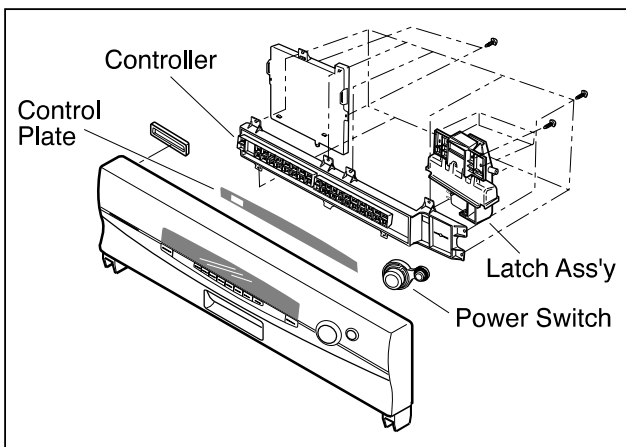

2) Control Panel Assembly

- ① Open the door.
 - ② Remove 4 screws(stainless).
 - ③ Remove wire connection.
- Be sure the wiring should not be changed in reassembling.
- ④ Remove 3 screws for Latch assembly
 - ⑤ Remove 5 screws for Controller.

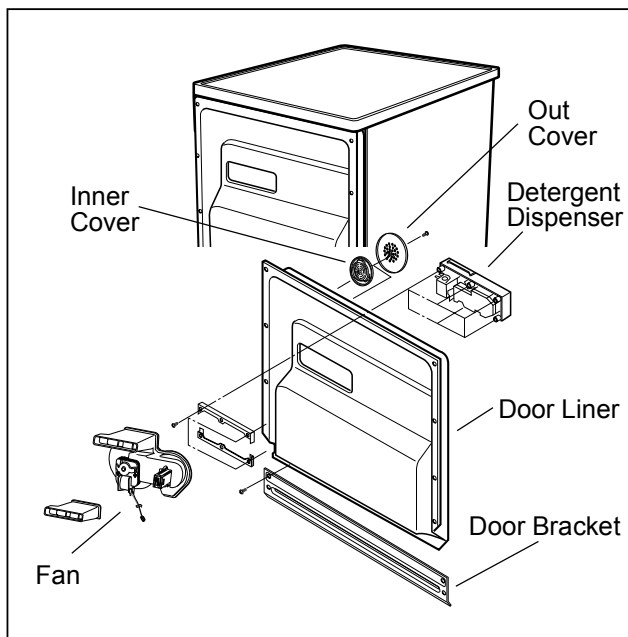

3) Fan(Not on all models)

- ① Open the door.
- ② Remove the wire connections.
- ③ Remove the outer cover by removing 1 screw.
- ④ Remove 2 fixing screws inside and turn the Inner Cover counterclockwise.

4) Detergent Dispenser

- ① Close the door.
- ② Remove the wire connections.
- ③ Remove 6 screws with brackets.

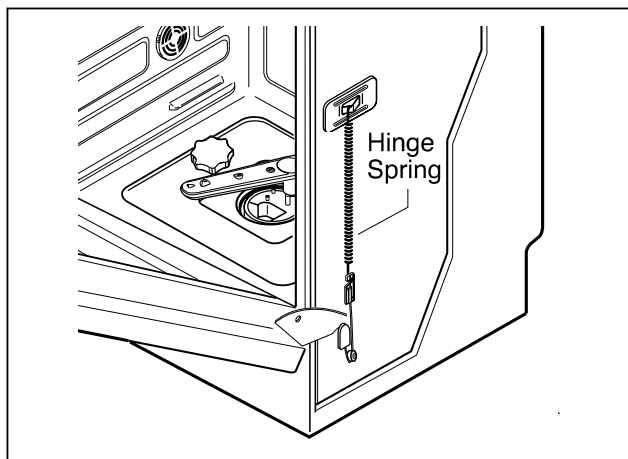

5) Door Spring (Right & Left)

- ① Push the Spring upwards and take it off from the Frame.
- Be careful not to be injured by the sharp edge of Tub.
- ② Take the Hinge Link off from the Hinge.

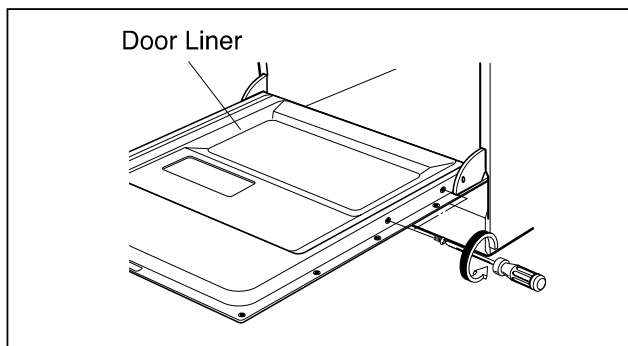

6) Door Liner

- ① Open the door.
 - ② Remove 4 screws.
- Do not use other screws for assembling.

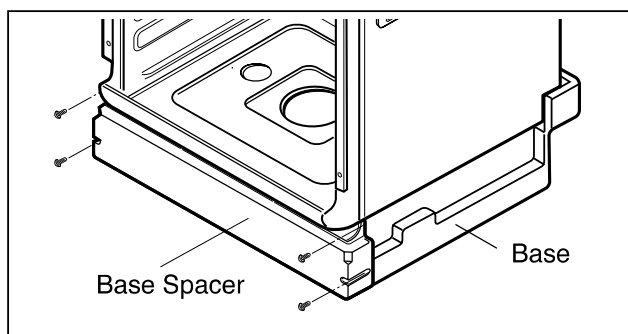

6. Base spacer

- ① Remove 4 screws.
- ② Lift the front side of dishwasher and pull the base spacer forward.

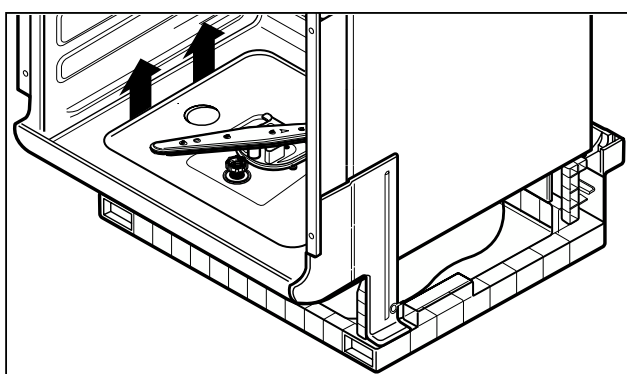

7. Tub assembly

1) Nozzle

- ① Pull up the nozzle.

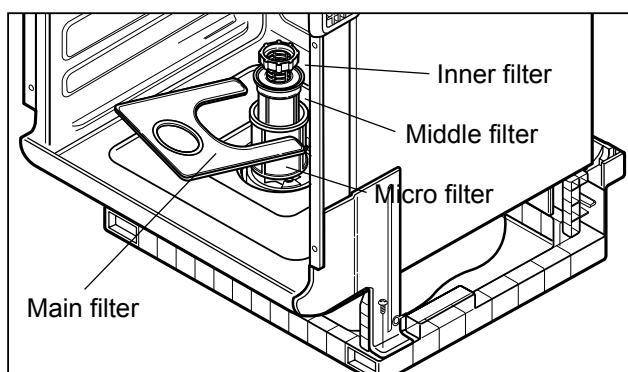

2) Filter Assembly

- ① Turn inner filter counterclockwise and lift inner filter and middle filter.

You can disassemble inner filter and middle filter by pulling opposite direction.

- ② Lift up main filter.
- ③ Lift up micro filter.

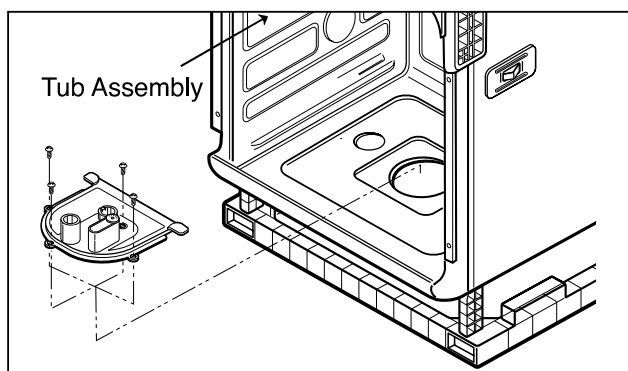

3) Nozzle Holder

- ① Disconnect the water guide
- ② Remove 4 screws and lift it up

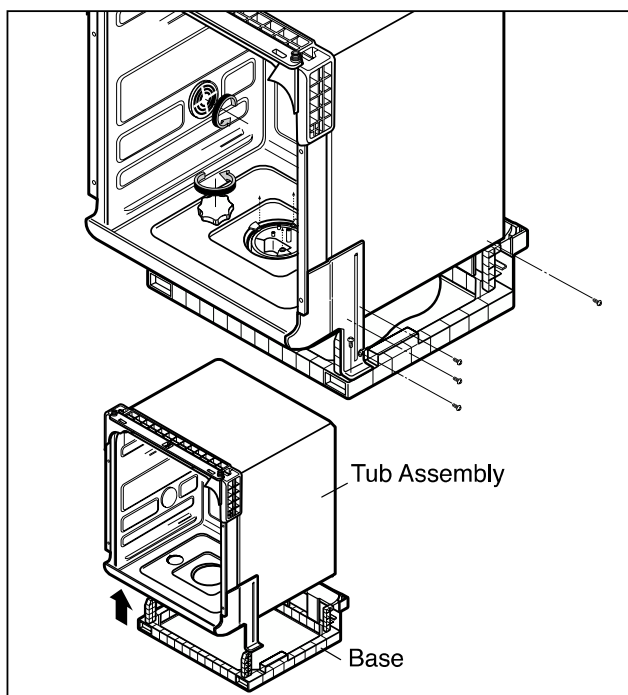

4) Tub

- ① Turn the air guide nut counter-clockwise.
(Special tool might be needed.)

Be careful the rubber packing of air guide assembly should not be lost.

- ② Turn the softner cap and nut counter-clockwise.
- ③ Remove 4 screws for sump holder .
- ④ Remove side 8 screws.
- ⑤ Remove 2 Earth screw of right side.
- ⑥ Lift tub assembly upward.
(Be sure water softner is not blocked.)

Be careful not to be injured or scratch floor by the sharp edge of tub.

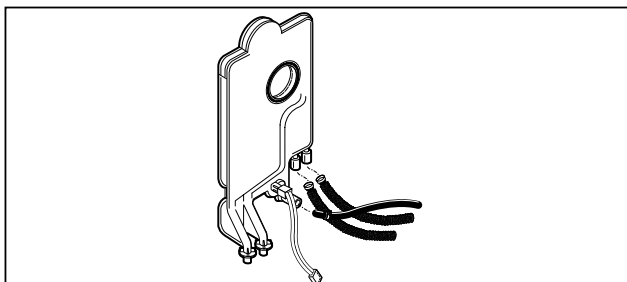

8. Air Guide Assembly

- ① Disconnect the wiring connection.
- ② Remove 3 hoses assembly.

Be careful the o-ring should not be lost.

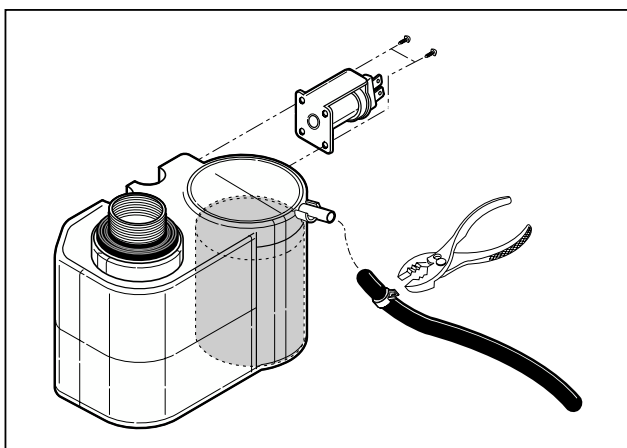

9. Water softner

- 1) Remove the hose assembly.
- 2) Lift it upward.

Be careful not to wet the floor by the water left in the water softner.

- 3) You can disassemble the regeneration valve by unscrew the 2 screw.

Be sure not to lost the spring and bobbin.

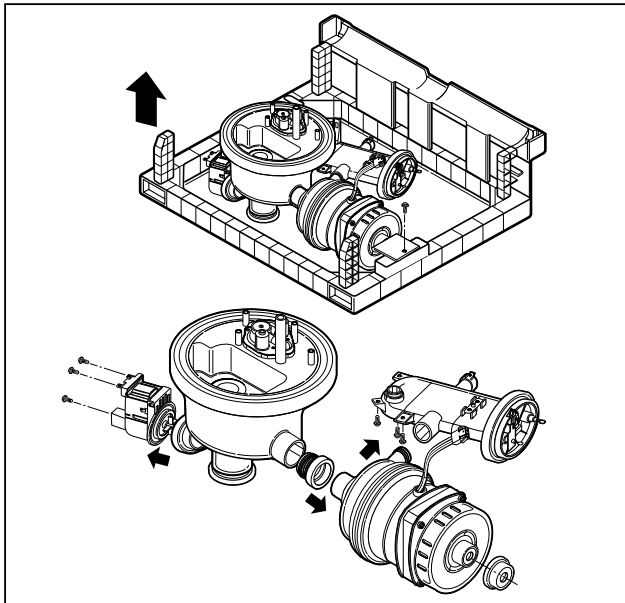

10. C-Base Assembly

- 1) Remove the screw which tighten washing motor and base.
- 2) Lift them upward.

Be careful not to wet the floor by the water left in the sump.

- 3) Detach the washing motor and heater assembly by pulling opposite direction to sump.
- 4) Remove the 3 screw for drain motor.

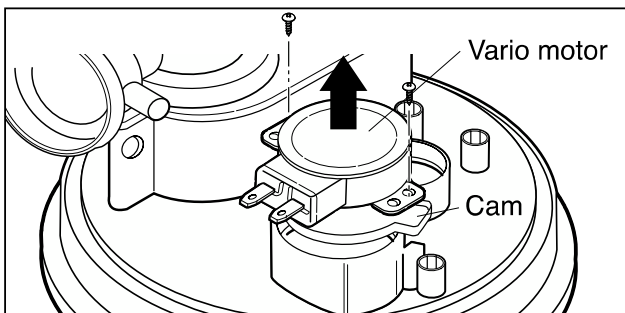

5) synchronous motor

- ① Remove the 2 screws.
 - ② Lift the cam upward.
- ※ Be careful not to install upside down.
(part number on the cam should face the motor.)

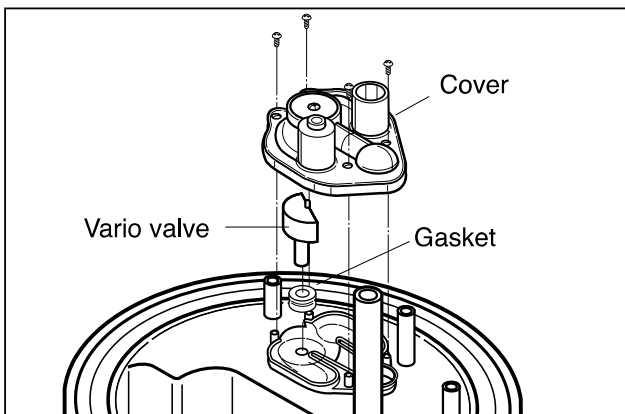

6) Vario valve

- ① Remove 4 screws and lift the cover upward.
- ② Lift the vario valve upward.

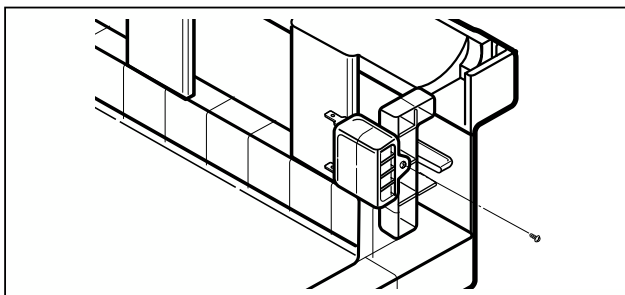

7) Capacitor

- ① Remove 1 screw.

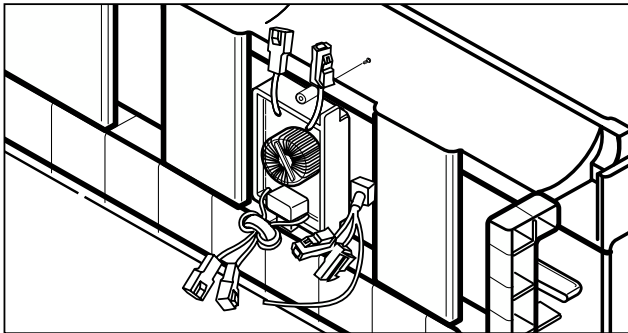

8) Noise filter

- ① Remove 1 screw.

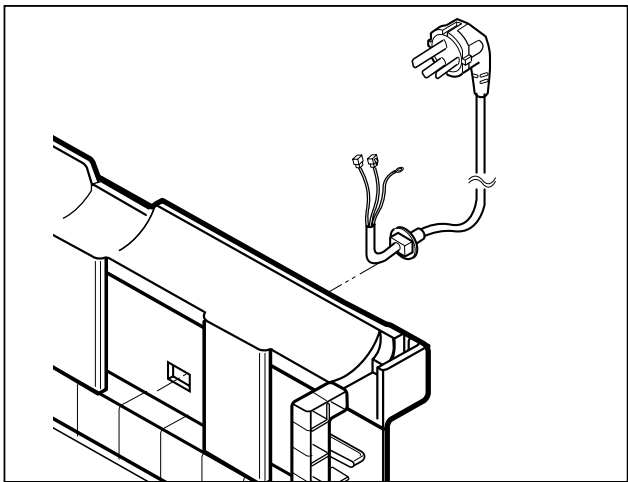

9) Power cord assembly

- ① Turn the power cord assembly 90° and take it off.

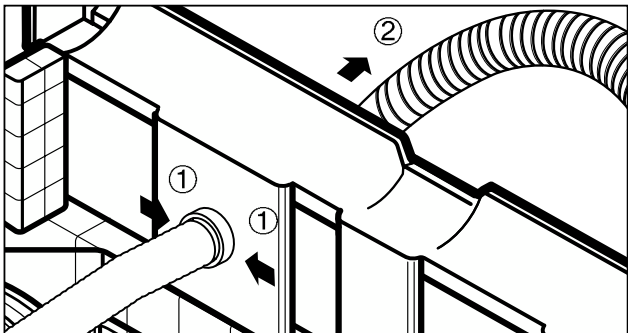

10) Aquastop(Not on all models)

- ① Press the holder hook as shown in figure.
- ② Pull the hose assembly.

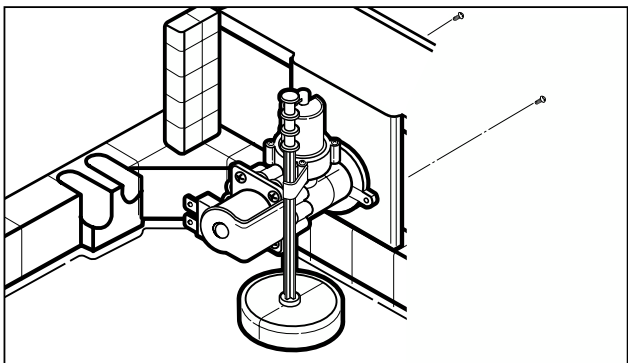

10) Inlet valve(on applicable models)

- ① Remove 2 screws.

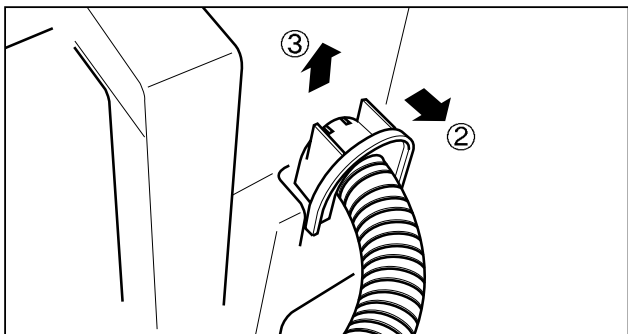

11) Drain Hose

- ① Press the rear side hook.
- ② Pull the holder forward.
- ③ Pull the holder upward.

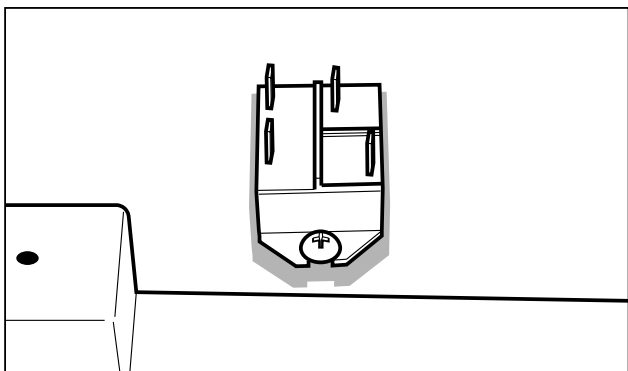

12) Relay

- ① Remove 2 screws.

7-2. DISASSEMBLE C-BASE ASSEMBLY

Be careful not to be injured by the sharp edge of tub.

1. Top Plate

- See 7-1. 1. (Page 15)

2. Low Cover

- See 7-1. 2. (Page 15)

3. Cabinet-R/L

- See 7-1. 3. (Page 15)

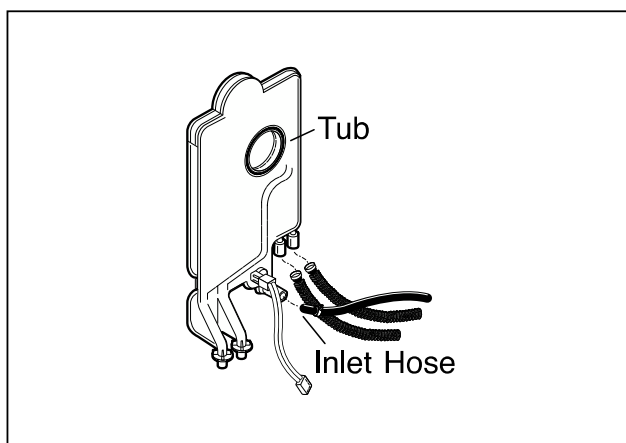

4. Air Guide

- ① Disconnect 3 hoses assembly.
- ※ You need not to unscrew the air guide nut.

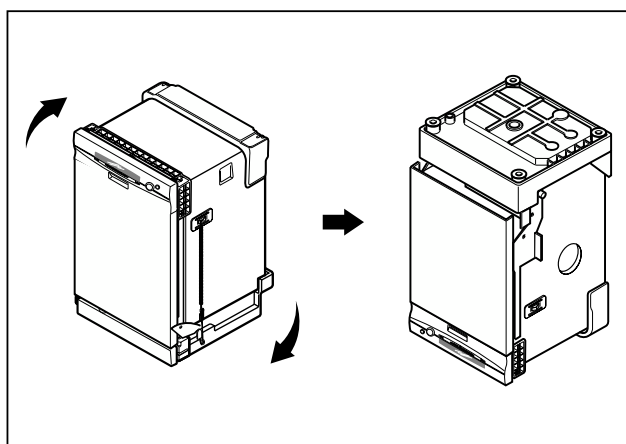

5. Put the Dishwasher upside down.

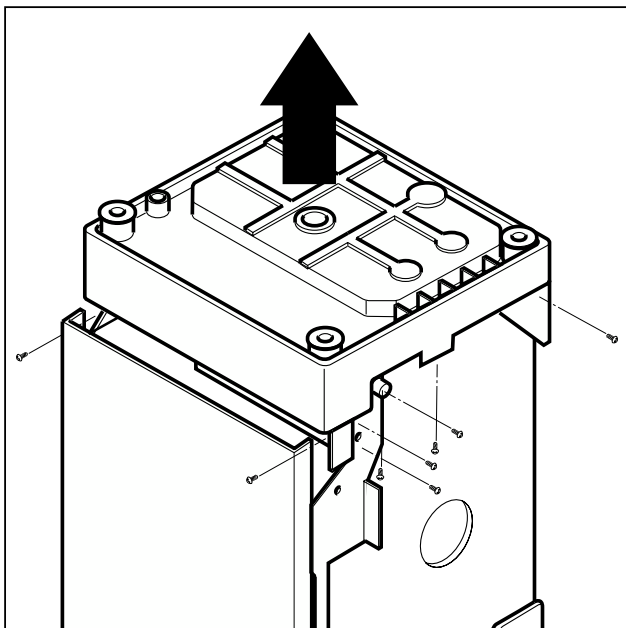

6. Remove the side screws

- 1) Remove side 8 screws.
- 2) Remove 2 Earth screws of right side.
- 3) Remove 1 motor bracket screw.
- 4) Lift base upward slightly.
(You can't lift up base perfectly because of some parts connecting to base.)

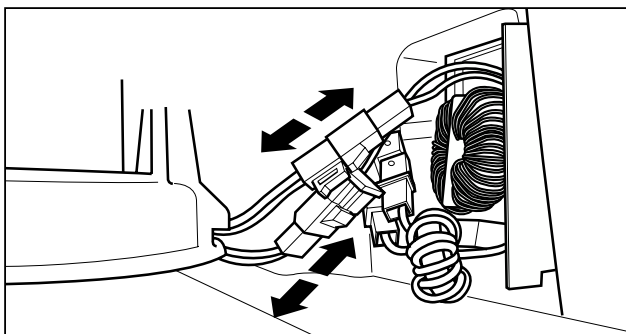

7. Disconnect the connecting points between tub and base

- 1) Disconnect noise filter.
- 2) Disconnect of powercord assembly.

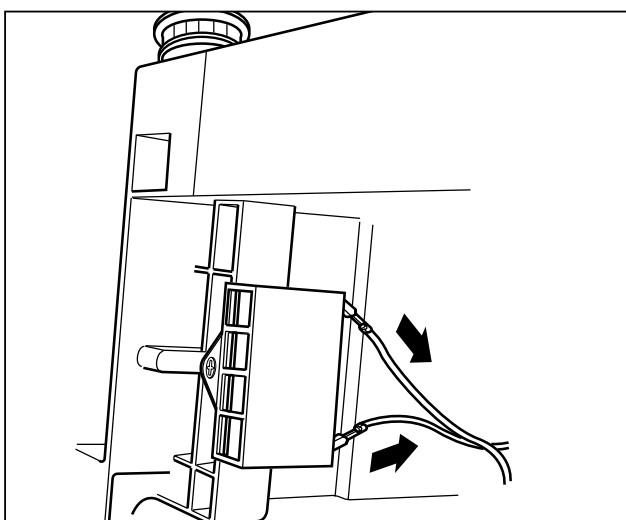

- 3) Disconnect wire from the capacitor.

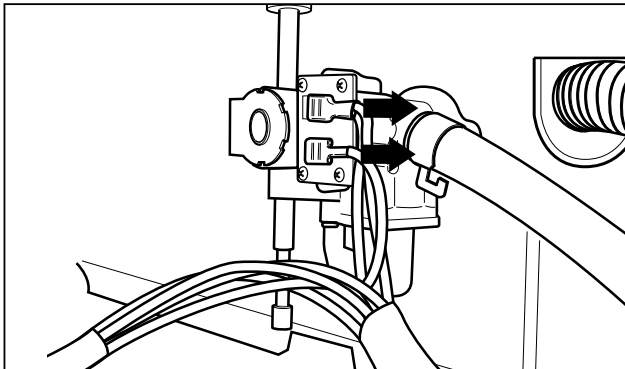

4) Disconnect wire from the inlet valve.
(Aquastop)

※ Now, you can remove the base from the tub perfectly.

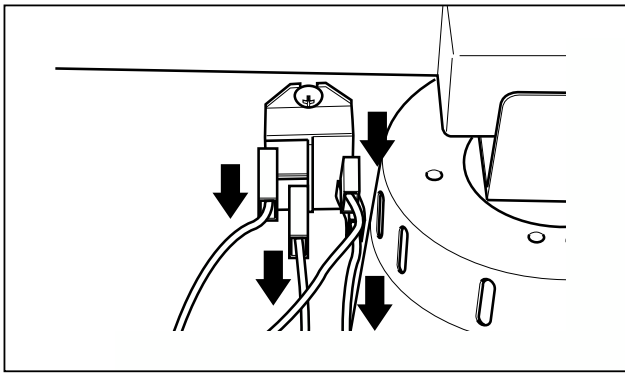

5) Disconnect wire from the relay.

※ Now, you can remove the base from the tub perfectly.

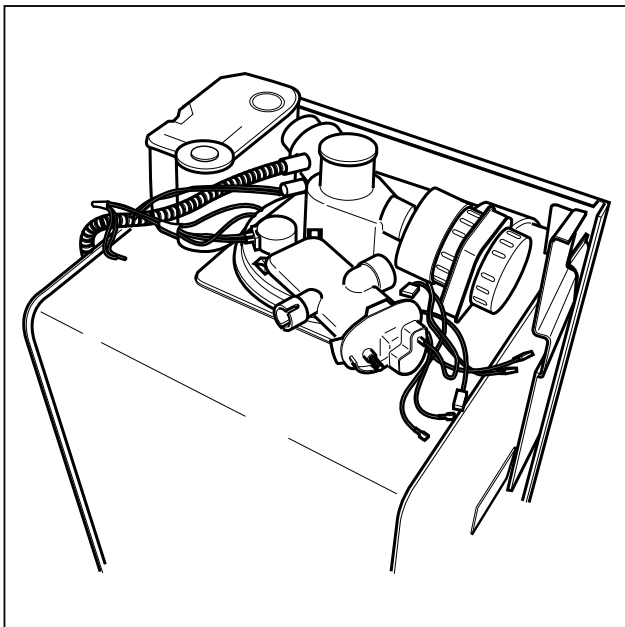

8. C-Base Assembly

※ You can repair the parts in the C-Base like heater case, washing pump, drain motor etc. you may refer to 7-1. 10. 2)~12) (Page 21~22)

※ Don't disassemble sump by 7-2.

If you want to disassemble the sump, follow 7-1.