

## Necessary Tools



- A) Plier
- B) Flat head thin screwdriver
- C) Cordless screwdriver or classic screwdriver with torx head (T20)

## 1. Disconnection



1.1. Remove the plug

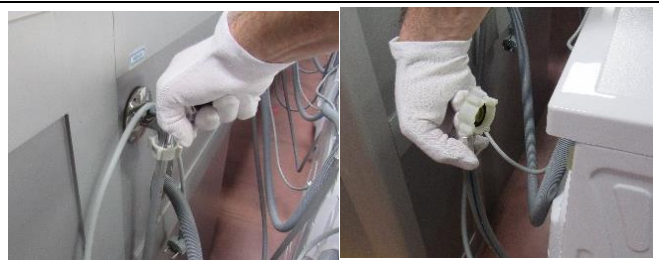

1.2. Turn off the tap and disconnect the hose from the valve



1.3. Disconnect the drain hose

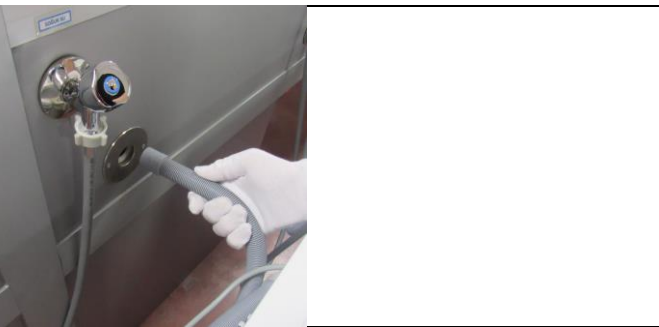

## 2) Disassembly Instructions

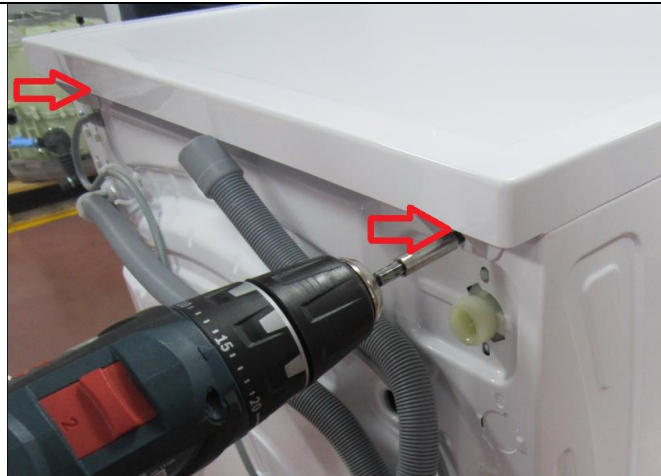

2.1. Remove two screws that fix the top-plate at the back.



2.2. Push the top-plate back and pull it up.

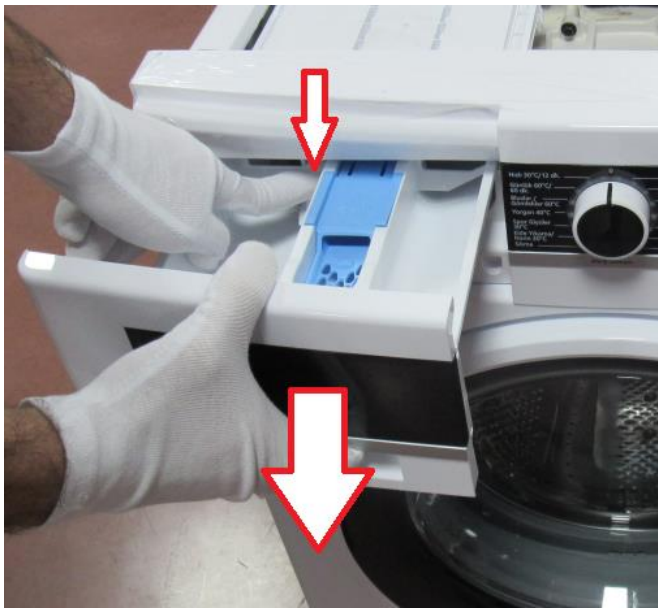

2.3. While pressing siphon cover keep pulling drawer to remove it.

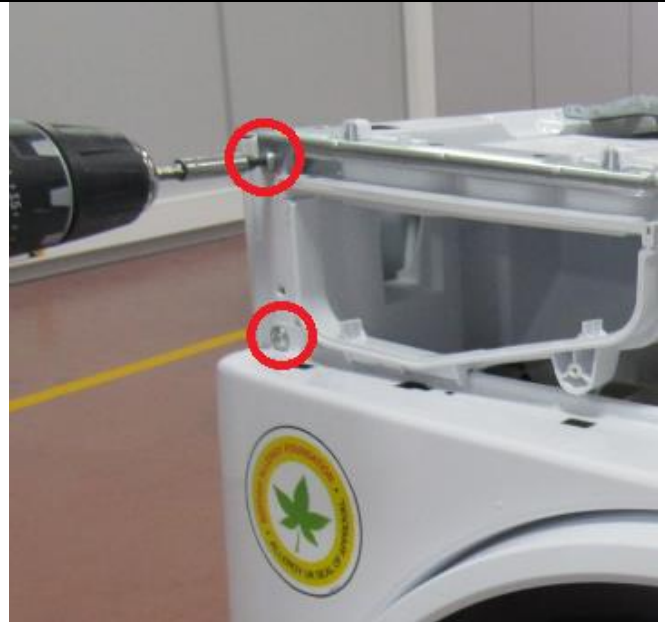

2.4. Remove the screw on support bracket and two screws fixing front panel to body



2.5. Remove the screw fixing twinjet elbow.



2.6. Remove the screws fixing the door lock.

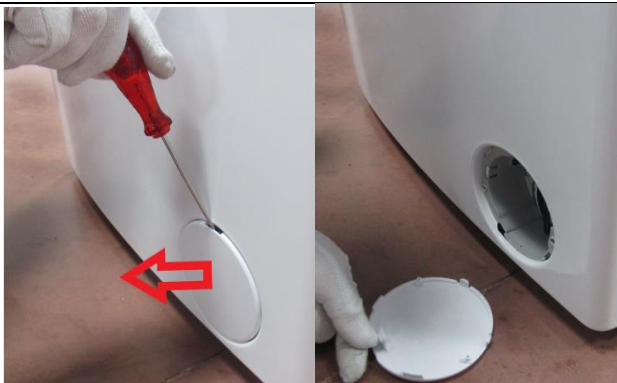

2.7. Remove the screw and plastic part located under the pump cover



2.8. Remove the screw fixing the front panel at the bottom.

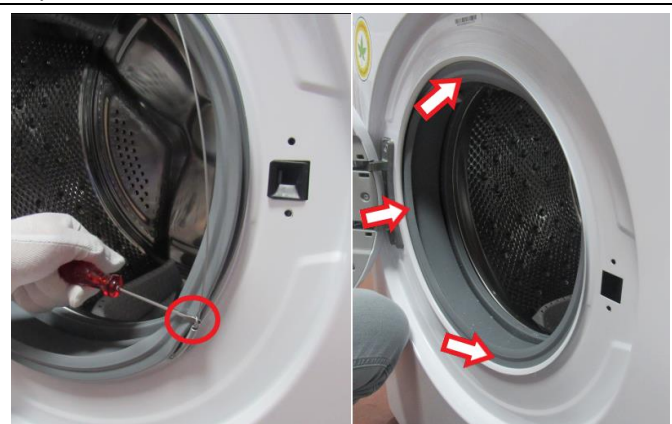

2.9. Remove the wire by using small screwdriver and push the seal to the inside

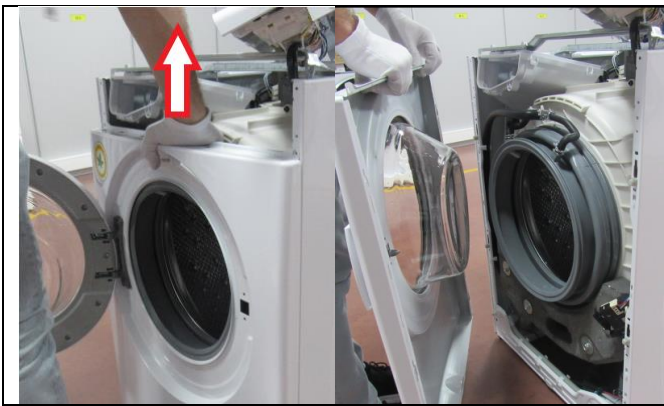

2.10. Pull up and remove the front panel.

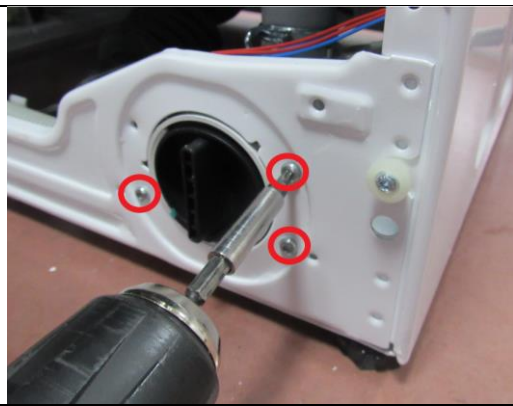

2.11. Remove screws holding drain pump

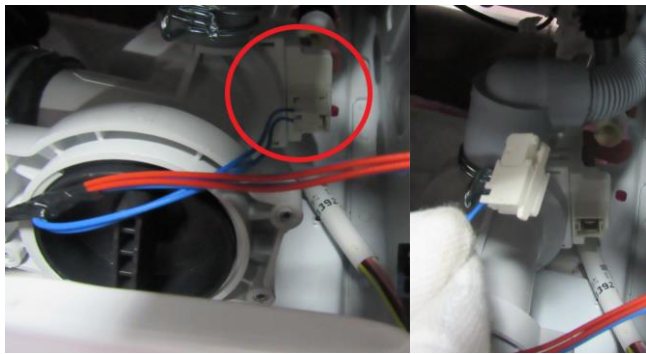

2.12. Remove the drain pump connector



2.13. Remove clamp fixing tub outlet hose by using a plier



2.14. Remove clamp holding drain hose by using a plier.



2.15. Remove clamp holding twinjet hose by using a plier.



2.16. Remove the drain pump and change with the new one

**3. Assembly Instructions**



3.1. Connect the twinjet hose by using a plier to fix the clamp

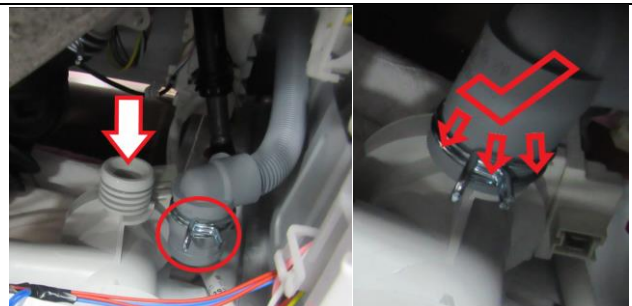

3.2. Connect the drain hose by using a plier to fix the clamp

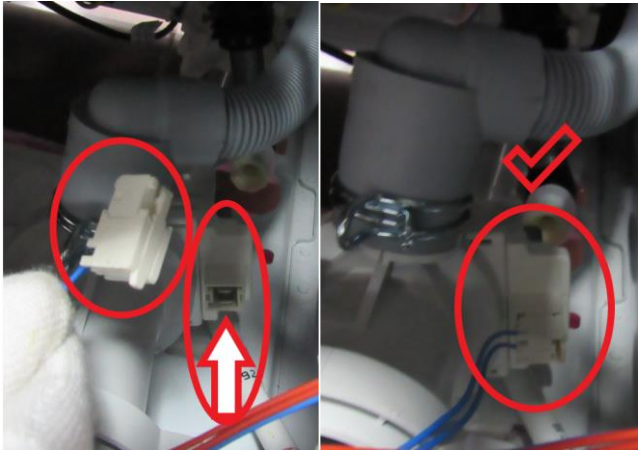

3.3. Connect the drain pump connector

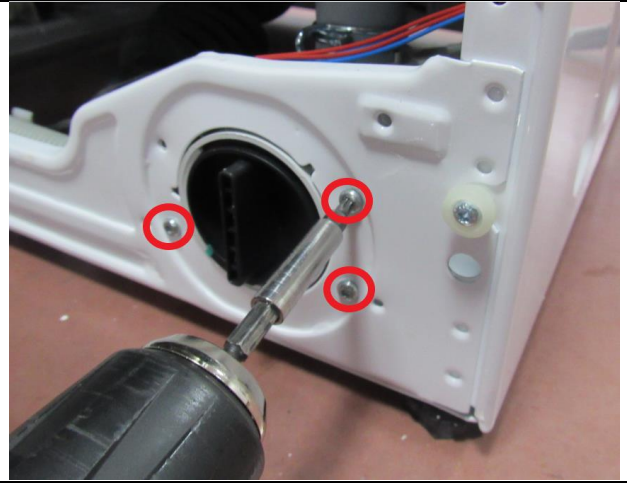

3.4. Tighten the screws holding drain pump



3.5. Pull the tub bellow seal to the outside and assemble the wire by using small screwdriver



3.6. Tighten the screw fixing the front panel at the bottom

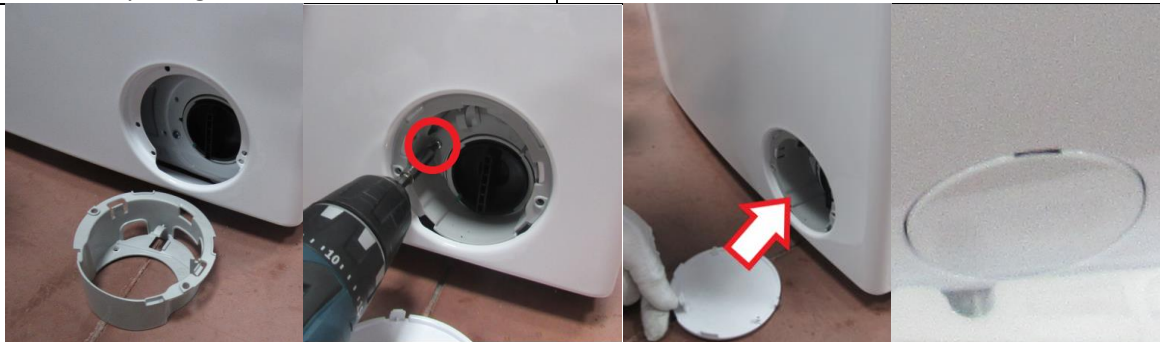

3.7. Tighten the screw and plastic part located under the pump cover



3.8. Assemble the twinjet elbow to the front panel

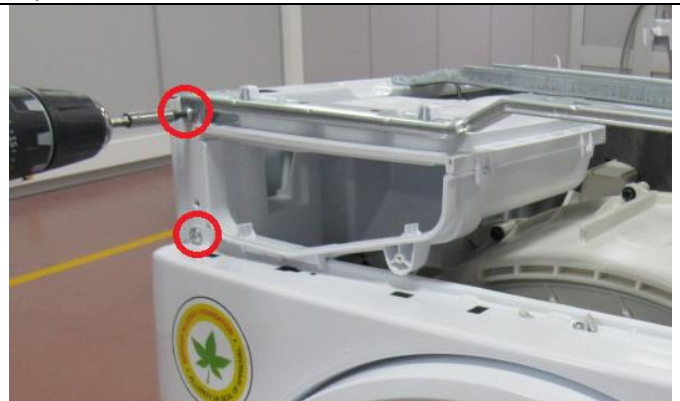

3.9. Tighten the screw on support bracket and two screws fixing front panel to body

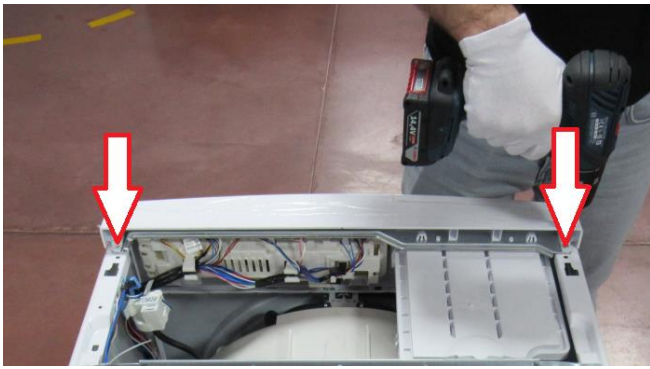

3.10. Tighten two screws fixing control panel.



3.11. Tighten the screw which fixes the control panel to the front panel.

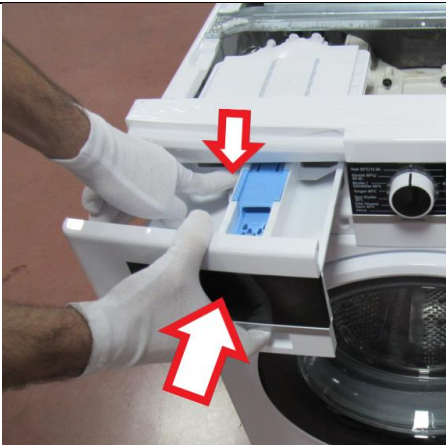

3.12. While pressing siphon cover keep pushing drawer to fit it.

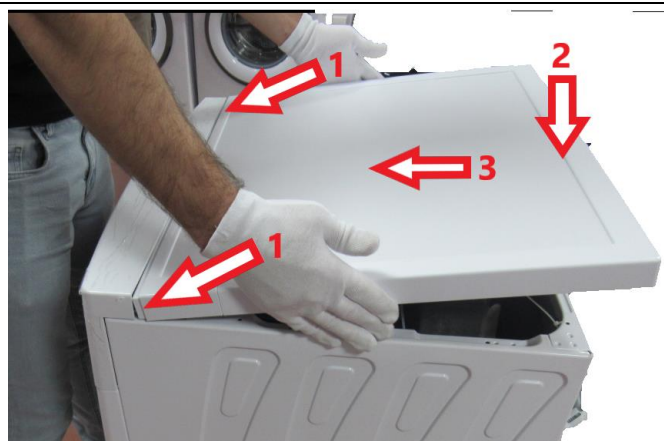

3.13. Fit the upper tray according to movement above

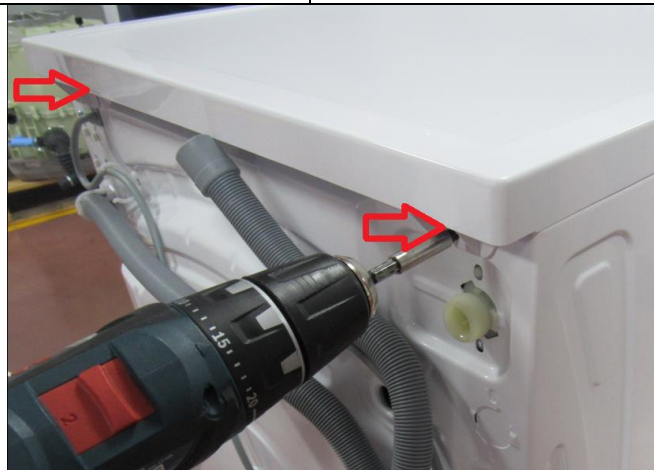

3.14. Tighten two screws that fix the top-plate at the back